

## 代码编制规则 Part Number

1	2	3	4	5	6	7	8	9	10	11	12	13	14	15
F	C	R	1	G	A	W	1	0	5	K	0	A	B	A
电容器类型 Capacitor type	产品外形 Product Shape	额定电压代码 Rated Voltage Code	系列代码 Series Code		容量代码 Capacitance Code		容量偏差 Capacitance Tolerance		外形 Shape	长度 Length	引线直径 Lead Diameter	引线长度 Lead Diameter		
FC=Film Capacitor	Axial=R	160=1G	CBB267=AW		1.0=105		± 5%=J		Circular=O	22=A	0.6=A	35=A		
		250=2F			10=106		± 10%=K			28=B	0.8=B	45=C		
		330=3D								44/46=F	1.0=C			
		400=4A								58/59=H	1.2=D			
		450=4F								34/36=I				
										54=S				
											48=C			

## Features

- Used in AC circuits as input or output filter
- PP film design, good temperature characteristics
- Stable capacity
- Low ESR, high RMS current handling capabilities
- Self-healing property
- Wrapped with polyester adhesive tape and ends filled with flame retardant epoxy resin

## 特点

- AC电路输入输出滤波
- 采用聚丙烯薄膜，温度特性好
- 容值稳定，变化率小
- 等效串联电阻小，承受较大的有效值电流
- 有自愈性
- 外包聚氨酯胶带纸，两端灌注阻燃性环氧

## Applications

- Solar inverters,
- UPS power supply
- Motor Driver systems

## 应用场合

- 太阳能逆变器
- UPS电源
- 电机驱动

## 外形图 Dimensions

Unit: mm

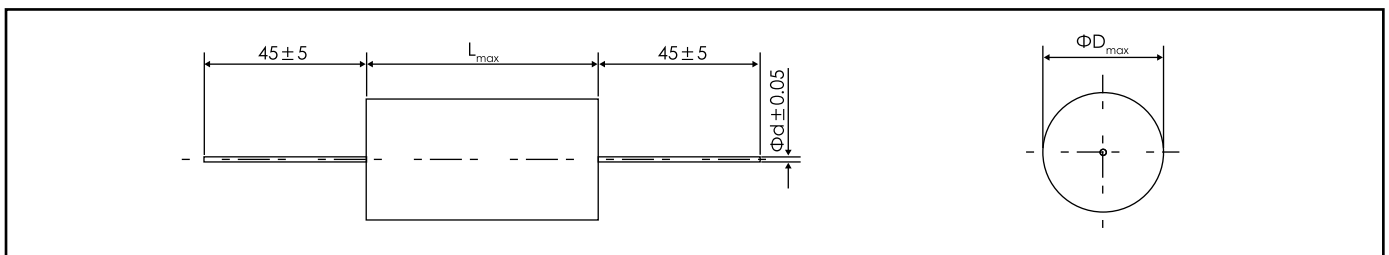

## 标识 Marking

	_____	1
CBB267	_____	2
1 μF K 250V	_____	3
F05	_____	4

NO.	项目 Item
1	商标 Brand
2	产品系列 Products series
3	容量、偏差以及额定电压 Capacitance、Tolerance and Rated voltage
4	日期代码 Date code

## 性能特性 Specifications

项目 Item	特性 Characteristics
引用标准 Reference Standard	GB/T 17702 (IEC 61071)
气候类别 Climatic Category	40/105/56
工作温度范围 Operating Temperature Range	-40~+105°C
存储温度范围 Storage Temperature Range	-40~+105°C
额定电压 $U_R$ Rated Voltage	160~450V <sub>AC</sub>
电容量范围 Capacitance Range	0.15~40μF
电容量偏差 Capacitance Tolerance	±5%(J), ±10%(K)
端子与端子电压 $U_{TT}$ Voltage Between Terminals	2.15 $U_N$ ( $V_{DC}$ ), 10s (20°C)
端子与外壳电压 $U_{TC}$ Voltage Between Terminals and Case	3000 $V_{AC}$ , 10s (20°C, 50Hz)
损耗角正切 Dissipation Factor	0.001 (20°C, 1KHz)
介质损耗角正切 Dielectric Dissipation Factor	0.0002
绝缘电阻 Insulation Resistance	≥30000MΩ • μF (20°C, 100V <sub>DC</sub> , 1min)
预期寿命 Life Expectancy	100000 hours ( $U_R$ , $\theta_{holspot}=70^\circ\text{C}$ )
失效率 Failure Rate	100 FIT

## 规格标准 Standard Ratings

U <sub>R</sub>	C <sub>R</sub>	P/N	dV/dt	I	R <sub>s</sub>	I <sub>max</sub>	ESL	L <sub>max</sub>	D <sub>max</sub>	d
(V)	(μF)	-	(V/μs)	(A)	100kHz (mΩ)	100kHz 70°C(A)	(nH)			(mm)
160	1.00	FCR1GAW105*OAB*	60	60.0	8.7	6.0	12	22.0	11.0	0.8
160	2.20	FCR1GAW225*OIB*	30	66.0	14.2	6.0	20	34.0	11.5	0.8
160	2.50	FCR1GAW255*OIB*	30	75.0	12.7	7.0	20	34.0	12.0	0.8
160	3.00	FCR1GAW305*OIC*	30	90.0	10.7	8.0	20	34.0	13.5	1.0
160	3.30	FCR1GAW335*OIC*	30	99.0	9.8	9.0	20	34.0	14.0	1.0
160	4.00	FCR1GAW405*OIC*	30	120.0	8.3	9.0	20	34.0	15.5	1.0
160	5.00	FCR1GAW505*OIC*	30	150.0	7.0	9.0	20	34.0	17.0	1.0
160	6.80	FCR1GAW685*OIC*	30	204.0	5.7	9.0	20	34.0	19.5	1.0
160	10.00	FCR1GAW106*OFC*	20	200.0	6.9	9.0	25	44.0	20.0	1.0
160	10.00	FCR1GAW106*OCC*	20	200.0	12.4	9.0	25	48.0	20.0	1.0
160	15.00	FCR1GAW156*OFD*	20	300.0	5.1	12.0	25	44.0	24.5	1.2
160	20.00	FCR1GAW206*OFD*	20	400.0	4.4	12.0	25	44.0	28.0	1.2
160	20.00	FCR1GAW206*OCD*	20	400.0	10.7	12.0	25	48.0	28.0	1.2
160	25.00	FCR1GAW256*OFD*	20	500.0	4.0	12.0	25	44.0	31.0	1.2
160	30.00	FCR1GAW306*OHD*	15	450.0	5.2	12.0	30	58.0	29.0	1.2
160	40.00	FCR1GAW406*OHD*	15	600.0	4.6	12.0	30	58.0	33.5	1.2
160	40.00	FCR1GAW406*OHD*	15	600.0	8.8	12.0	30	58.0	36.0	1.2
250	0.47	FCR2FAW474*OBB*	60	28.2	14.4	6.0	15	28.0	9.5	0.8
250	0.68	FCR2FAW684*OIB*	45	30.6	15.2	6.0	20	34.0	10.0	0.8
250	1.00	FCR2FAW105*OIB*	45	45.0	10.8	7.0	20	34.0	12.0	0.8
250	1.50	FCR2FAW155*OIC*	45	67.5	75.0	9.0	20	34.0	14.5	1.0
250	2.00	FCR2FAW205*OIC*	45	90.0	6.1	9.0	20	34.0	16.5	1.0
250	2.20	FCR2FAW225*OIC*	45	99.0	5.7	9.0	20	34.0	17.5	1.0
250	2.50	FCR2FAW255*OIC*	45	112.5	5.2	9.0	20	34.0	18.5	1.0
250	3.00	FCR2FAW305*OIC*	45	135.0	4.7	9.0	20	34.0	20.0	1.0
250	3.30	FCR2FAW335*OFC*	30	99.0	6.8	9.0	25	44.0	18.0	1.0
250	4.00	FCR2FAW405*OFC*	30	120.0	6.0	9.0	25	44.0	19.5	1.0
250	4.70	FCR2FAW475*OFC*	30	141.0	5.3	9.0	25	44.0	21.0	1.0
250	5.00	FCR2FAW505*OFC*	30	150.0	5.2	9.0	25	44.0	21.5	1.0
250	6.80	FCR2FAW685*OFD*	30	204.0	4.2	12.0	25	44.0	25.0	1.2
250	10.00	FCR2FAW106*OFD*	30	300.0	3.5	12.0	25	44.0	30.0	1.2
250	15.00	FCR2FAW156*OHD*	20	300.0	6.2	12.0	30	58.0	31.5	1.2
250	20.00	FCR2FAW206*OHD*	20	400.0	5.2	12.0	30	58.0	35.0	1.2
330	0.47	FCR3DAW474*OIB*	60	28.2	17.0	6.0	20	34.0	11.0	0.8
330	0.68	FCR3DAW684*OIB*	60	40.8	12.2	7.0	20	34.0	13.0	0.8
330	1.00	FCR3DAW105*OIC*	60	60.0	8.6	9.0	20	34.0	15.5	1.0
330	2.00	FCR3DAW205*OFC*	40	80.0	8.2	9.0	25	44.0	18.5	1.0
330	2.20	FCR3DAW225*OFC*	40	88.0	6.8	9.0	25	44.0	19.5	1.0
330	3.00	FCR3DAW305*OFC*	40	120.0	6.2	9.0	25	44.0	22.5	1.0
330	3.30	FCR3DAW335*OFD*	40	132.0	5.6	12.0	25	44.0	23.5	1.2
330	4.00	FCR3DAW405*OFD*	40	160.0	4.9	12.0	25	44.0	25.5	1.2
330	4.70	FCR3DAW475*OFD*	40	188.0	4.6	12.0	25	44.0	27.5	1.2
330	5.00	FCR3DAW505*OFD*	40	200.0	4.4	12.0	25	44.0	28.5	1.2
330	6.80	FCR3DAW685*OHD*	30	204.0	8.8	12.0	30	58.0	28.5	1.2
330	10.00	FCR3DAW106*OHD*	30	300.0	6.9	12.0	30	58.0	34.5	1.2
400	0.47	FCR4AAW474*OIC*	80	37.6	12.4	8.0	20	34.0	14.5	1.0
400	0.68	FCR4AAW684*OIC*	80	54.4	9.1	9.0	20	34.0	17.0	1.0
400	1.00	FCR4AAW105*OIC*	80	80.0	6.8	9.0	20	34.0	20.5	1.0
400	1.50	FCR4AAW155*OFC*	60	90.0	8.3	9.0	25	44.0	20.5	1.0
400	2.00	FCR4AAW205*OFD*	60	120.0	6.5	12.0	25	44.0	23.5	1.2
400	2.20	FCR4AAW225*OFD*	60	132.0	6.1	12.0	25	44.0	24.5	1.2
400	3.00	FCR4AAW305*OFD*	60	180.0	5.1	12.0	25	44.0	28.5	1.2
400	3.30	FCR4AAW335*OFD*	60	198.0	4.8	12.0	25	44.0	30.0	1.2
400	4.00	FCR4AAW405*OFD*	60	240.0	4.6	12.0	25	44.0	33.0	1.2
400	4.70	FCR4AAW475*OHD*	40	188.0	10.3	12.0	30	58.0	29.5	1.2
400	5.00	FCR4AAW505*OHD*	40	200.0	9.8	12.0	30	58.0	30.5	1.2
400	6.80	FCR4AAW685*OHD*	40	272.0	7.9	12.0	30	58.0	35.0	1.2
450	0.15	FCR4FAW154*OIB*	210	31.5	18.9	5.0	20	34.0	10.0	0.8
	0.22	FCR4FAW224*OIB*	210	46.2	13.4	7.0	20	34.0	12.0	0.8
450	0.33	FCR4FAW334*OIC*	210	69.3	9.2	9.0	20	34.0	14.5	1.0
450	0.47	FCR4FAW474*OIC*	210	98.7	7.0	9.0	20	34.0	17.0	1.0
450	0.68	FCR4FAW684*OIC*	210	142.8	5.5	9.0	20	34.0	20.5	1.0
450	1.00	FCR4FAW105*OFC*	140	140.0	6.1	9.0	25	44.0	20.5	1.0

FILM

## 规格标准 Standard Ratings

$U_R$	$C_R$	P/N	dV/dt	$\hat{i}$	$R_s$	$I_{max}$	ESL	$L_{max}$	$D_{max}$	d
(V)	( $\mu$ F)	-	(V/ $\mu$ S)	(A)	100KHz (m $\Omega$ )	100KHz 70 $^{\circ}$ C(A)	(nH)			
450	1.50	FCR4FAW155*OFD*	140	210.0	4.6	12.0	25	44.0	24.5	1.2
450	2.00	FCR4FAW205*OFD*	140	280.0	4.0	12.0	25	44.0	28.5	1.2
450	2.20	FCR4FAW225*OFD*	140	308.0	3.9	12.0	25	44.0	29.5	1.2
450	2.50	FCR4FAW255*OFD*	140	350.0	3.8	12.0	25	44.0	31.5	1.2
450	3.00	FCR4FAW305*OHD*	90	270.0	4.7	12.0	30	58.0	28.0	1.2
450	3.30	FCR4FAW335*OHD*	90	297.0	4.6	12.0	30	58.0	29.5	1.2
450	4.00	FCR4FAW405*OHD*	90	360.0	4.2	12.0	30	58.0	32.5	1.2

可根据客户要求定制。Customer products are available on request.

## 预期寿命曲线 Expected lifetime curve

