

1. PART NO. EXPRESSION :

S S P 1 0 0 9 M R 1 9 L F
 (a) (b) (c) (d) (e)(f)

(a) Series code

(b) Dimension code

(c) Type code

(d) Inductance code : R19 = 185nH

(e) Tolerance code : M = $\pm 20\%$, L = $\pm 15\%$, K = $\pm 10\%$

(f) F : RoHS Compliant

2. CONFIGURATION & DIMENSIONS :

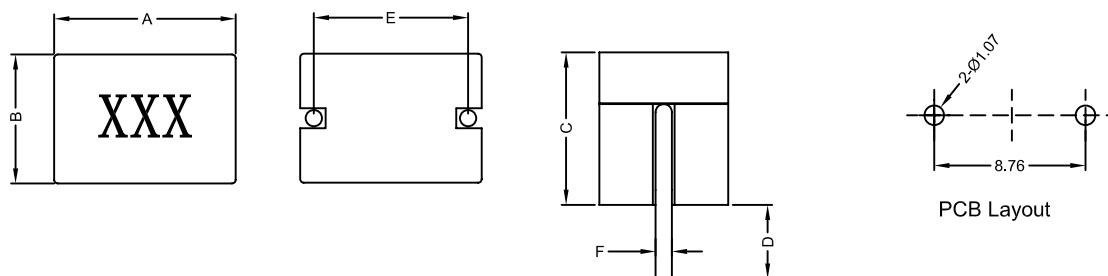

Unit:m/m

A	B	C	D	E	F
10.0 Max.	9.0 Max.	10.0 Max.	3.5 ± 0.5	8.76 ± 0.5	$\varnothing 0.8$

3. SCHEMATIC :

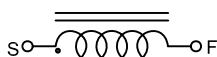

4. MATERIALS ::

- a) Core : Ferrite Core
- b) Clip : Copper
- c) Wire : 2UEW

5. GENERAL SPECIFICATION :

- (a) Operating temp. : -20°C to $+125^{\circ}\text{C}$
- (b) Storage condition (component in its packaging)
 - i) Temperature : -10 to 40°C
 - ii) Humidity : 60%



RoHS Compliant

NOTE : Specifications subject to change without notice. Please check our website for latest information.

18.09.2015



SUPERWORLD ELECTRONICS (S) PTE LTD

PG. 1

6. ELECTRICAL CHARACTERISTICS :

Part No.	Inductance L0 (nH) ±15%	Test Frequency (Hz)	DCR (mΩ)±4,6% @ 25°C	Isat (A) ≧80%L0	Irms (A) ΔT≧40°C
SSP1009MR19LF	185	100K/1V	0.64	72	35
SSP1009MR22LF	220	100K/1V	0.64	63	35
SSP1009MR27LF	270	100K/1V	0.64	50	35
SSP1009MR33LF	335	100K/1V	0.64	40	35
SSP1009MR47LF	470	100K/1V	0.64	27	35

**RoHS Compliant**

NOTE : Specifications subject to change without notice. Please check our website for latest information.

18.09.2015

**SUPERWORLD ELECTRONICS (S) PTE LTD**

7. SOLDERING AND MOUNTING :

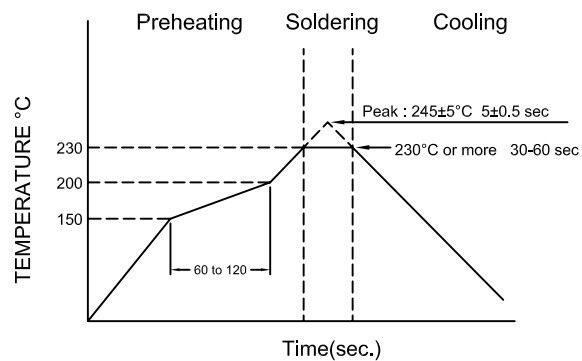

Figure 1. Re-flow Soldering

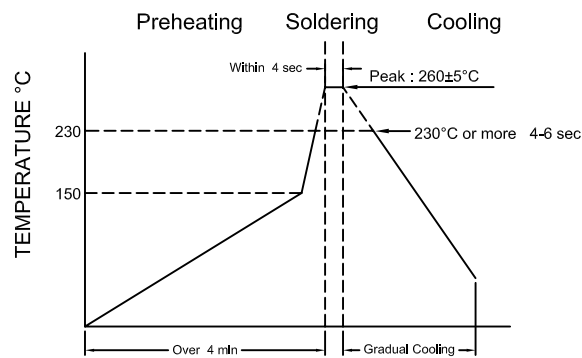

Figure 2. Wave Soldering

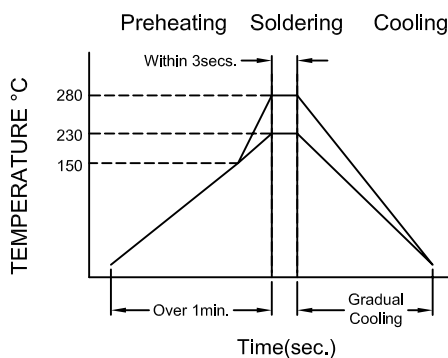

Figure 3. Hand Soldering



RoHS Compliant

NOTE : Specifications subject to change without notice. Please check our website for latest information.

18.09.2015



SUPERWORLD ELECTRONICS (S) PTE LTD

8. PACKAGING INFORMATION :

(1) Tray Dimension

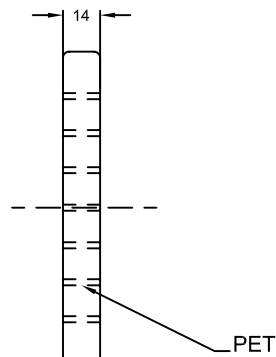
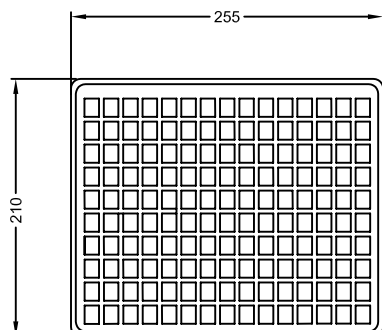

PET Size: 255*210*14m/m

QUANTITY: 150PCS/PET

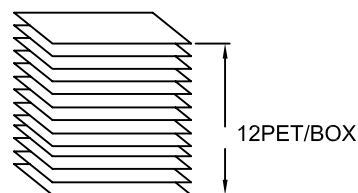
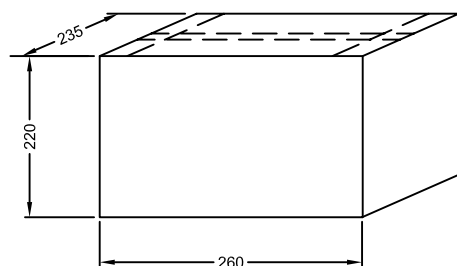

BOX SIZE: 260*235*220m/m

QUANTITY: 12PET/BOX

(2) Packaging Quantity

P/N	Chip/Tray	Carton
SSP1009M	150pcs	1800pcs



RoHS Compliant

NOTE : Specifications subject to change without notice. Please check our website for latest information.

18.09.2015



SUPERWORLD ELECTRONICS (S) PTE LTD

Storage

- a) Recommended products should be used within 6 months from the time of delivery.
- b) The packaging material should be kept where no chlorine or sulfur exists in the air.

Transportation :

- a) Products should be handled with care to avoid damage or contamination from perspiration and skin oils.
- b) The use of tweezers or vacuum pick up is strongly recommended for individual components.
- c) Bulk handling should ensure that abrasion and mechanical shock are minimized.



RoHS Compliant

NOTE : Specifications subject to change without notice. Please check our website for latest information.

18.09.2015



SUPERWORLD ELECTRONICS (S) PTE LTD

PG. 5