

1. PART NO. EXPRESSION :

S D L 1 1 T 0 8 P - R 2 5 M F - □□

(a) (b) (c) (d) (e)(f) (g)

(a) Series code

(b) Dimension code

(c) Material code

(d) Inductance code : R25 = 0.25uH

(e) Tolerance code : M = ±20%

(f) F : RoHS Compliant

(g) 10 : Standard

11 ~ 99 : Internal control number

2. CONFIGURATION & DIMENSIONS :

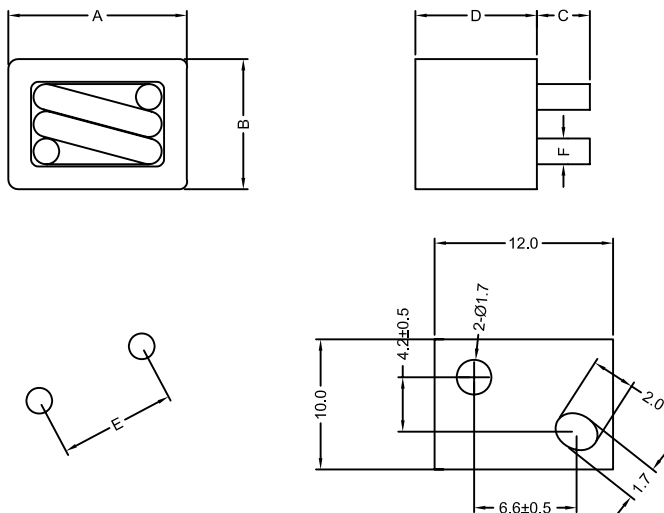

Unit:m/m

A	B	C	D	E	F
11.7 Max.	9.7 Max.	3.5±0.5	8.5 Max.	7.8±0.5	∅1.4±0.1

3. SCHEMATIC :

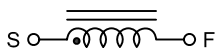

4. MATERIALS :

(a) Core

(b) Wire

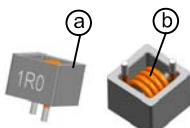

RoHS Compliant

NOTE : Specifications subject to change without notice. Please check our website for latest information.

18.09.2015



SUPERWORLD ELECTRONICS (S) PTE LTD

PG. 1

5. GENERAL SPECIFICATION :

- (a) Operating temp. : -40° C to +125° C
- (b) Storage condition (component in its packaging)
 - i) Temperature : -10 to 40° C
 - ii) Humidity : 60%

6. ELECTRICAL CHARACTERISTICS :

Part No.	Inductance L0 (uH) ±20%	Test Frequency (Hz)	DCR (mΩ)±8% @ 25±5°C	Isat		I _{rms} (A) Typ. ΔT ≧ 40°C
				(A) Typ.	Condition	
SDL11T08P-R25MF	0.25	100K/1V	0.65	50	≧ 95% L0	43
SDL11T08P-R30MF	0.30	100K/1V	0.65	45	≧ 85% L0	43



RoHS Compliant

NOTE : Specifications subject to change without notice. Please check our website for latest information.

18.09.2015



SUPERWORLD ELECTRONICS (S) PTE LTD

7. CHARACTERISTICS CURVES :

7.1 INDUCTANCE (nH) VS DC BIAS (Amps)

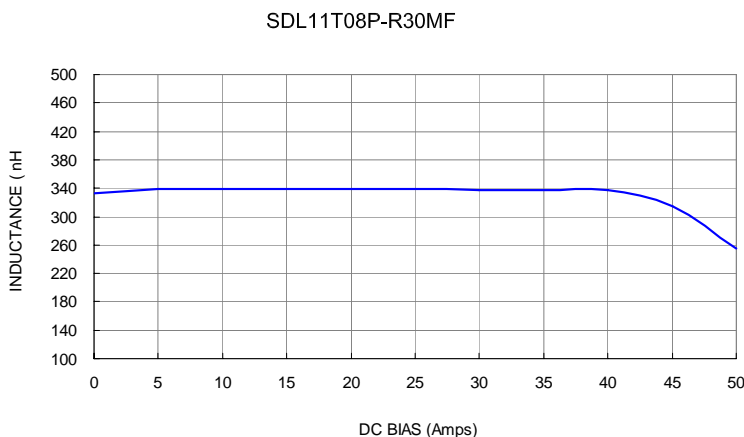
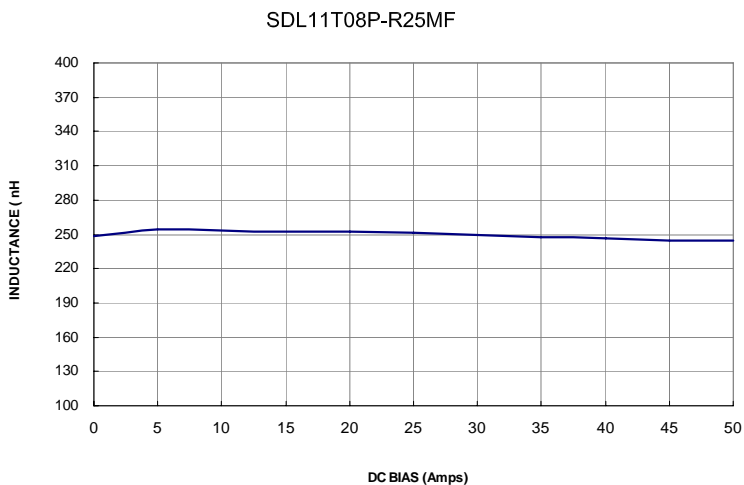

RoHS Compliant

NOTE : Specifications subject to change without notice. Please check our website for latest information.

18.09.2015



SUPERWORLD ELECTRONICS (S) PTE LTD

7.2 TEMPERATURE RISE ΔT ($^{\circ}C$) VS DC BIAS (Amps)

SDL11T08P-R25MF

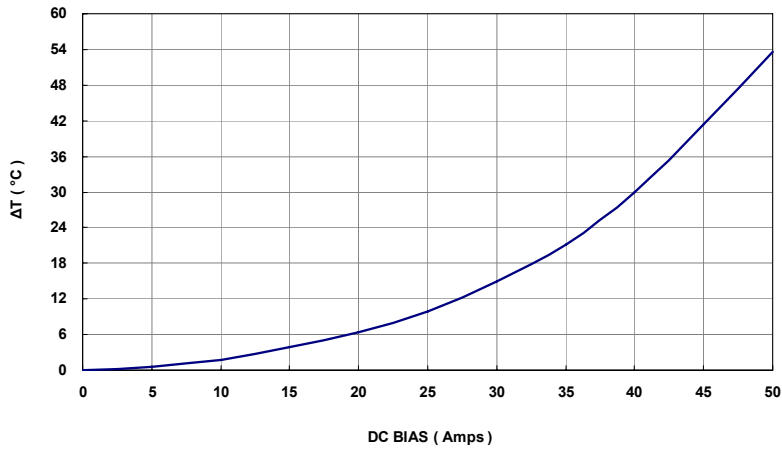

SDL11T08P-R30MF

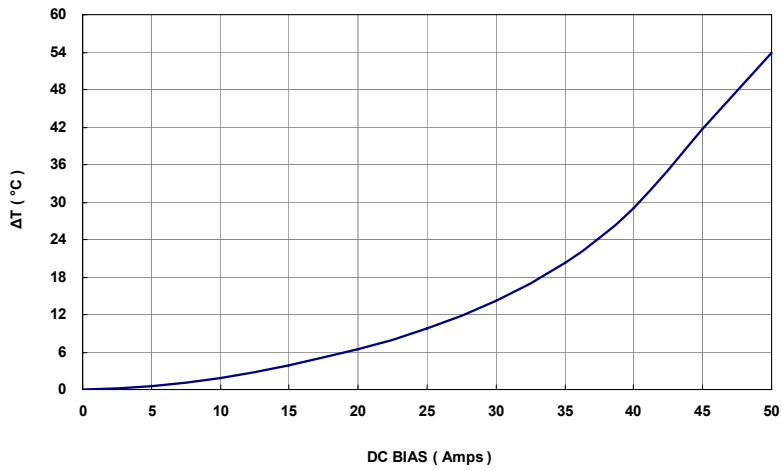

RoHS Compliant

NOTE : Specifications subject to change without notice. Please check our website for latest information.

18.09.2015



8. SOLDERING AND MOUNTING :

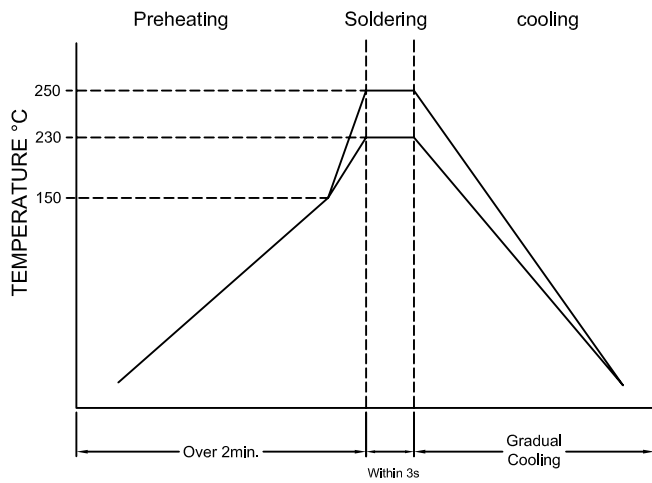

Figure 1. Wave Soldering

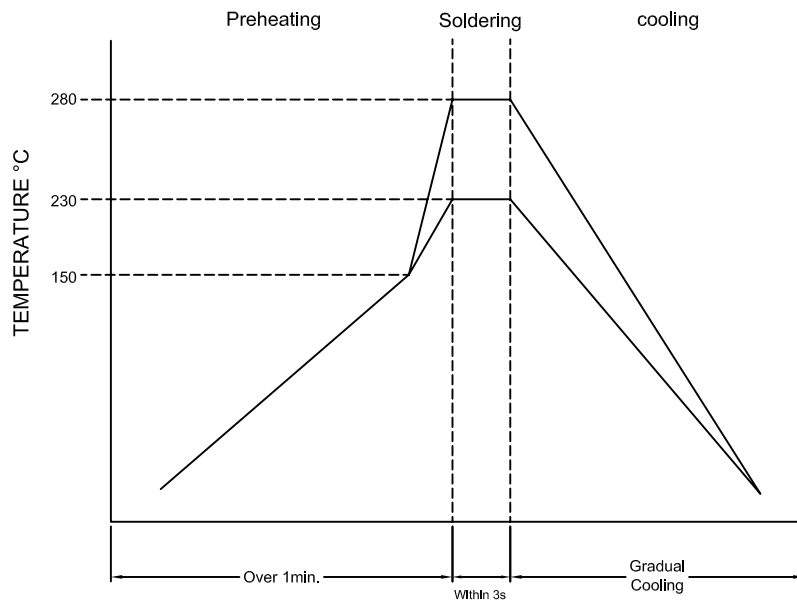

Figure 2. Hand Soldering



RoHS Compliant

NOTE : Specifications subject to change without notice. Please check our website for latest information.

18.09.2015



SUPERWORLD ELECTRONICS (S) PTE LTD

9. PACKAGING INFORMATION :

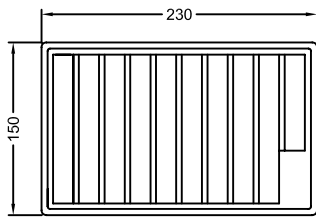

PVC SIZE: 230*150*12m/m

QUANTITY: 120/PVC

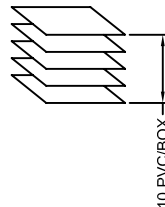
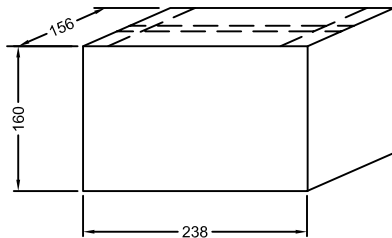
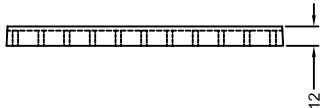

INBOX SIZE: 238*156*160m/m

QUANTITY: 10PVC/BOX

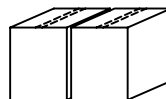
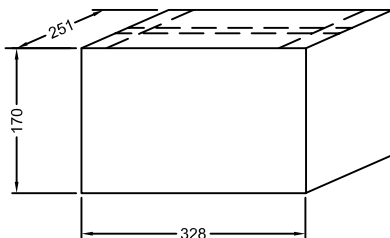

OUTBOX SIZE: 328*251*170m/m

QUANTITY: 2 INBOX/OUTBOX

Storage

- a) Recommended products should be used within 6 months from the time of delivery.
- b) The packaging material should be kept where no chlorine or sulfur exists in the air.

Transportation :

- a) Products should be handled with care to avoid damage or contamination from perspiration and skin oils.
- b) The use of tweezers or vacuum pick up is strongly recommended for individual components.
- c) Bulk handling should ensure that abrasion and mechanical shock are minimized.



RoHS Compliant

NOTE : Specifications subject to change without notice. Please check our website for latest information.

18.09.2015



SUPERWORLD ELECTRONICS (S) PTE LTD