

1. PART NO. EXPRESSION :

S M C 0 7 0 5 R 1 0 M Z F
 (a) (b) (c) (d)(e) (f)

- (a) Series code
- (b) Dimension code
- (c) Inductance code : R10 = 0.10uH

- (d) Tolerance code : M = ±20%
- (e) Z : Standard Products
- (f) F : RoHS Compliant

2. CONFIGURATION & DIMENSIONS :

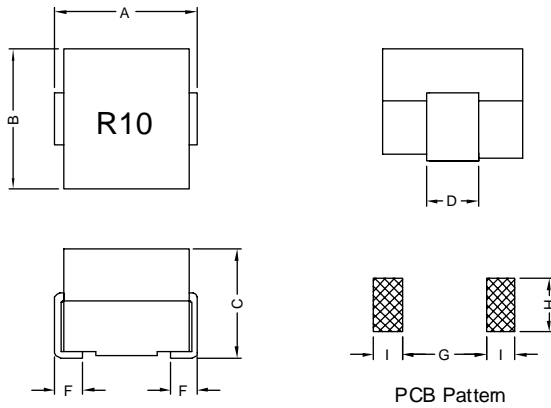

Unit : mm

A	B	C	D	F	G	H	I
7.00 Max.	7.00 Max.	5.00 Max.	2.50± 0.30	1.30± 0.20	3.3 Ref.	3.0 Ref.	2.0 Ref.

3. SCHEMATIC :



4. MATERIALS :

- a) Core
- b) Core
- c) Clip
- d) Adhesive

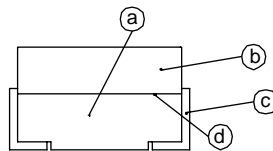

RoHS Compliant

NOTE : Specifications subject to change without notice. Please check our website for latest information.

05.01.2015



SUPERWORLD ELECTRONICS (S) PTE LTD

5. GENERAL SPECIFICATION :

- a) Temp. Rise : 40°C Max. at I_{rms}
- b) $\Delta L / L_0A$: 20% Max. at I_{sat}
- c) Operating Temperature : -40° C ---+125° C
- d) Storage condition (component in its packaging)
 - i) Temperature : -10 to 40° C
 - ii) Humidity : 60%

6. ELECTRICAL CHARACTERISTICS :

Part Number	Inductance (μ H)	Test Frequency (Hz)	DC Resistance ($m\Omega$) Max.	I _{sat} (A)	I _{rms} (A)
SMC0705R07MZF	0.072 \pm 20%	1V/100K	0.35	58	45
SMC0705R10MZF	0.105 \pm 20%	1V/100K	0.35	46	45
SMC0705R15MZF	0.150 \pm 20%	1V/100K	0.35	30	45



RoHS Compliant

NOTE : Specifications subject to change without notice. Please check our website for latest information.

05.01.2015



SUPERWORLD ELECTRONICS (S) PTE LTD

PG. 2

7. CHARACTERISTICS CURVES :

@ INDUCTANCE VS. FREQUENCY RESPONSE CURVE

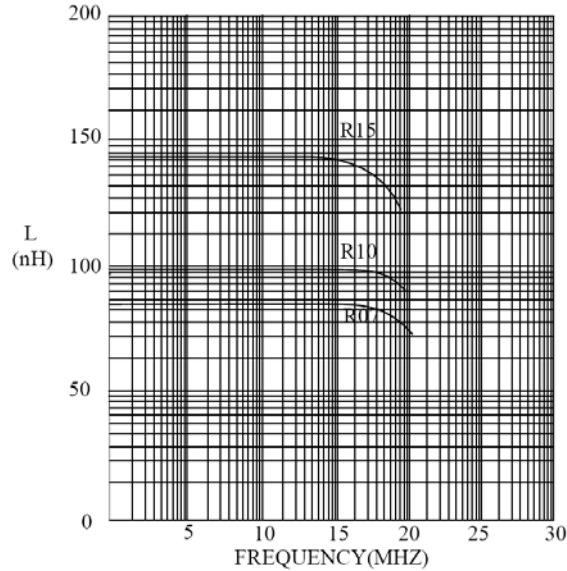

@ TEMP. RISE VS. DC SUPERPOSITION RESPONSE CURVE

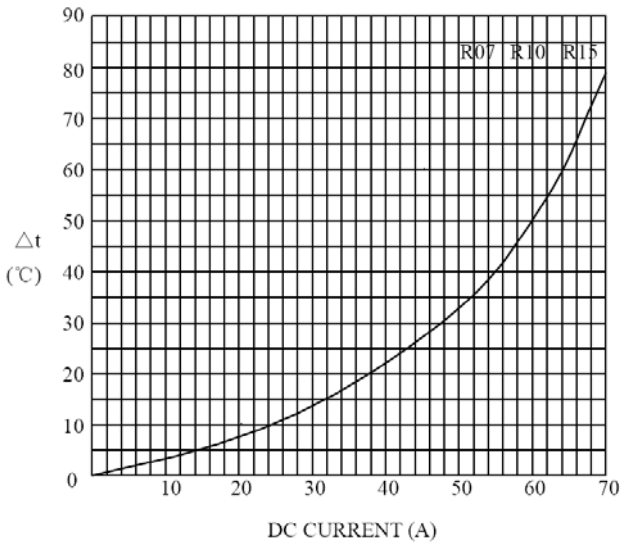

@ INDUCTANCE VS. DC SUPERPOSITION RESPONSE CURVE

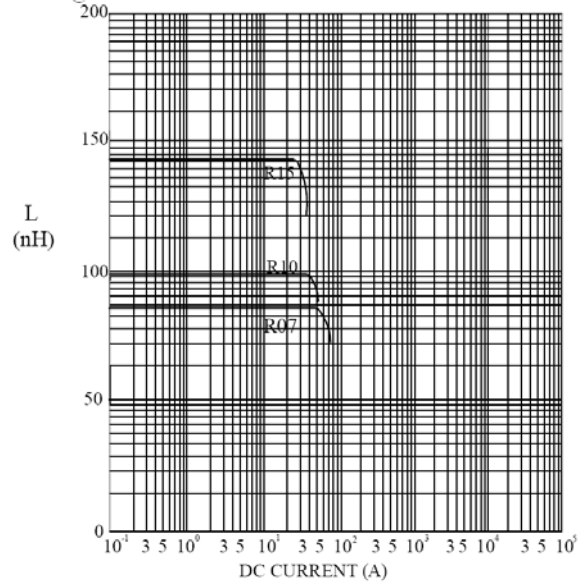

RoHS Compliant

NOTE : Specifications subject to change without notice. Please check our website for latest information.

05.01.2015



SUPERWORLD ELECTRONICS (S) PTE LTD

7. PACKAGING INFORMATION :

(1) CONFIGURATION

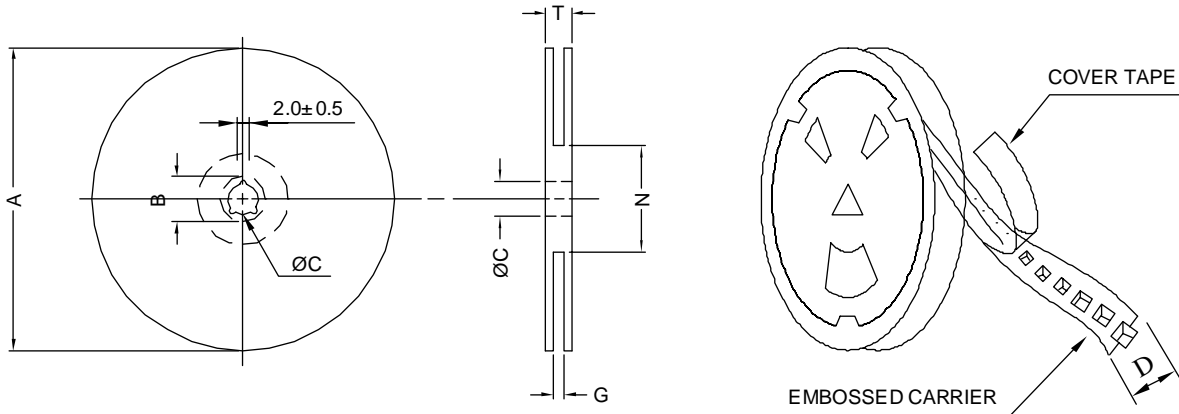

* CARRIER TAPE WIDTH : D

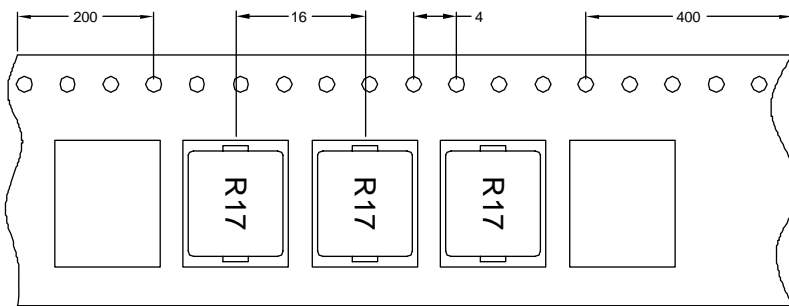

(2) DIMENSIONS

Unit:m/m

STYLE	A	B	C	D	G	N	T
13-16	330	21±0.8	13	16	18 ⁺⁰	50 ⁻⁰	22.4

(3) QTY & G.W. PER PACKAGE

SERIES	INNER : REEL			OUTER : CARTON		
	QTY (PCS)	G.W. (gw)	STYLE	QTY (PCS)	G.W. (Kg)	SIZE (cm)
SMC0705	1000	1440	13-16	6000	9.64	38 x 36.5 x 21



RoHS Compliant

NOTE : Specifications subject to change without notice. Please check our website for latest information.

05.01.2015



SUPERWORLD ELECTRONICS (S) PTE LTD